

# **Northwest Arkansas Forests and Drinking Water Workshop Final Report November 2016**

On September 15 and 16 of 2016, 46 leaders and stakeholders from Arkansas state agencies and Northwest Arkansas's forestry, drinking water, and conservation communities (Attachment A) convened in Russellville, Arkansas for a Northwest Arkansas Forests and Drinking Water Workshop. The purpose of the Workshop was to explore the connections between forests and drinking water, and to brainstorm specific ways to collaborate in Northwest Arkansas watersheds to continue to sustain these two very important and interdependent resources.

The Northwest Arkansas Forests and Drinking Water Workshop was convened with the knowledge that forests and drinking water are strongly connected and dependent on each other. Southeastern forests that are actively managed can help protect and increase drinking water supplies while also providing economic benefits. The **Workshop's primary goals and objectives were to:**

- **Stimulate and accelerate community-based watershed protection to benefit both forests and drinking water**
- **Give participants clear, actionable steps to improve water quality through forest land protection**
- **Provide regional examples of successful watershed protection efforts, tools, and messages**
- **Provide information about available watershed protection funding**
- **Discuss how to move forward collaboratively with at least one on-the-ground project to enhance forest and drinking water protection**

## **Background and History**

This Workshop is a direct result of the 2015 Arkansas Forests and Drinking Water Forum, focused on an area in the state that was identified in that Forum as a priority region for enhanced forest-drinking water partnership, collaboration, and watershed protection projects. The 2015 Forum was initiated and supported by the Southeastern Partnership for Forests and Water, a multi-year US Forest Service and US Endowment for Forestry and Communities funded project to develop regional, state and local watershed protection collaboration focused on the connection between forests and drinking water. The 2015 Arkansas Forests and Drinking Water Forum resulted in the creation of the Arkansas Forests and Drinking Water Committee. This Committee spent several months intensively planning this Northwest Arkansas Forests and Drinking Water Workshop to address the specific needs of the region.

## **Workshop Overview**

Many workshop participants and their guests gathered the afternoon of September 15 (Attachment B) to participate in a watershed restoration field trip sponsored by Beaver Water District, Beaver Watershed Alliance and the Watershed Conservation Resource Center. Field trip participants visited several local stream restoration and riparian buffer project sites focused on sediment and phosphorous reduction to Beaver Lake, a regional drinking water supply. Matt Van Eps of the Watershed Conservation Resource Center, John Scott (Urban Forester for the City of Fayetteville) and Hal Liechty of the University of Arkansas explained the rationale for investment in these projects as well as the multiple benefits they provide for the environment, quality of life, and educational opportunities for landowners, water and forest resource professionals. After the tour a dinner was provided for the participants to encourage additional networking and development of partnerships.

The Workshop agenda for Friday September 16th (Attachment B) began with a presentation by Dr. Bob Morgan on the background and history of the Arkansas Forests and Drinking Water Partnership and 2015 Forum. Then, Dr. Brian Haggard presented on watershed protection success factors, and Richard Krop with the Cadmus Group presented about the recent cost/benefit analysis conducted for Beaver Water District. Next, Arnold Hameister, Arkansas Forestry Commission shared a brief presentation of forestry Best Management Practices (BMP's) and results from the Arkansas BMP survey of forest industry operators. Next an Arkansas Forestry Association (AFA) Tree Farmer and Beaver Lake Watershed landowner Jim Woodruff presented about his experience with AFA's Tree Farm Program and perspective as a Beaver Lake Watershed steward. Jeff Berry with Green Bay Packaging, Inc. presented about the company's forest landowner timber management program focused on sediment and nutrient reduction to Brewer Lake, the drinking water supply for the Cities of Conway, Morrilton, Plumerville, and rural Conway County. Dr. Bob Morgan presented about the new dedicated source water protection funding mechanism established by Beaver Water District. John Pennington presented on the landowner-guided collaborative approach to implementing the Beaver Lake Watershed Protection Strategy, and Matt Van Eps of the Watershed Conservation Resource Center presented about a new NRCS-Regional Conservation Partnership Program to address streambank erosion, forest and pasture management in the Beaver Lake Watershed. The Workshop's afternoon was devoted to watershed-specific facilitated breakout group discussions.

## **Morning Group Discussion Points**

- The cost-benefit presentation makes it clear that forests are a long term land use that protect water quality more than other land use BMPs, such as at construction sites (due to temporal vs. sustained impact)
- The question was asked: What do representatives from the various watersheds in NW Arkansas need? The answer seemed to be watershed management plans, with a preference for nine-element watershed management plans:
  - having a nine-element watershed management plan can leverage funding

- Arkansas Department of Environmental Quality (ADEQ), Arkansas Dept. of Health (ADH), and Arkansas Rural Water Association can assist water utilities with plan development
- Other ways ADEQ and ADH can help:
  - Free technical assistance - Mulberry River Society gets assistance for example
  - ADH newsletter – has list of resources which include parcel info, GIS mapping tools
  - ADEQ can also help with watershed education and analysis
- There is a need to train individuals on forest health
- Jeff Berry – All timber needs to be managed, having a plan is helpful
- Max Braswell – There is a misperception that forests today are as they always have been, this needs to be overcome.
- Can water utilities be members of AFA? – Yes, we can find a way
- Will Beaver Water District adopt a forest management plan? – Yes
- Additional clarification about Beaver Water District (BWD) source water protection funding: BWD has the funds reserved through existing rate structure, so no rate increase is required right now. The reserve is made up of four cents for every 1,000 gallons sold, which generates over \$600,000 annually. Beaver Watershed Alliance uses a portion of the funds to implement the Beaver Lake Watershed Protection Strategy, including paying for staff, as well as conducting education/outreach and BMP programs. Funding also leverages (matches) additional grant funding such as NRCS Resource Conservation Partnership Program (RCPP).
- Cities, counties, agencies, corporations, and individuals all contribute to Beaver Watershed Alliance
- Cadmus cost-benefit chart shows watershed environmental benefits are huge
- Determine whether it is feasible for Mulberry to use the BWA-BWD model to consider expanding their effort to work with landowners, agencies, and non-profits, and potentially funding a non-profit to work with landowners and other stakeholders
- Conway is working on sustainable forest management for water quality
- Need a list of registered foresters to help watershed efforts with landowner outreach and projects
- Arkansas Forestry Commission (AFC) can help watershed efforts work with urban/suburban private landowners through the Urban Forestry & Tree City Programs
- Tree ordinances might be used to manage canopy on small lots
- NRCS Environmental Quality Incentives Program (EQIP) can be used for Western Arkansas woodland reforestation project
- Figure out ways to incentivize forest management (particularly in urban settings)
- All timber needs management and there is a need to get forests back to productive systems
- Generate good perceptions of what a healthy forest looks like and does

**Mulberry River Watershed Breakout Group Discussion** (Hugh Earnest, Channon Phipps, Max Braswell, Doug Akin, Jennifer Ogle, Scott Meek)

***What is going on in the Mulberry River Watershed?***

Hugh Earnest, private landowner and President of Mulberry River Society, provided information about this group. Mulberry River Society is a watershed protection organization that focuses on conservation, appreciation, recreation, education, and stewardship. Mulberry River Society has a board and is registered 501(c)(3). They typically invite about 150 stakeholders to meetings, and usually 20 to 30 people show up. They are working with ADEQ to identify pollution issues, and with US Forest Service to reconstruct Mulberry River Canoe Access.

Channon Phipps is Assistant Water Superintendent with City of Mulberry Drinking Water Utility. The drinking water supply watershed is 7.5 square miles in the Mulberry watershed, and is composed of three main tributaries. The City of Mulberry is very interested in having forestry BMPs established and implemented because they are vital to water quality. They are using the AFC BMP guidebook; If they focus on the shoreline management zone, this doesn't cost very much but can result in large benefits especially through restoration cost avoidance.

***Is there is a watershed management plan?***

There is currently no watershed management plan, but City of Mulberry has a source water protection plan.

***Who are the key players?***

- ☺ Mulberry River Society,
- ☺ US Forest Service,
- ☺ City of Mulberry,
- ☺ private landowners,
- ☺ ADEQ,
- ☺ Arkansas Department of Rural Services,
- ☺ Franklin Co. Extension Service & NRCS,
- ☺ Arkansas Natural Heritage Commission,
- ☺ Arkansas Natural Resources Commission,
- ☺ Arkansas Department of Health,
- ☺ Arkansas Forestry Commission, and
- ☺ Arkansas Forestry Association.

***Strengths, Weaknesses, and Opportunities***

Mulberry River Society is in a "building momentum" stage and can serve as a watershed champion. They have consistent and dedicated staff and stakeholders, and are working on increasing capacity on their committees. They would like to identify and utilize more champions. The City of Mulberry is also in the "building momentum" stage. They understand that their water supply is the source of future economic growth and development and quality of life, and are beginning to think of ways they can proactively protect their water supply in a voluntary manner to encourage landowner participation.

Opportunities exist to provide assistance with developing landowner and community education/awareness/outreach programs about the forests-drinking water connection and

BMP implementation. Also need assistance developing watershed management plan, and understanding water quality issues like acidification on the Mulberry River. Need financial assistance to increase effectiveness of Mulberry River Society and implementation of landowner BMP's.

***Priority and Long-term Actions (📍 indicates priority actions or next steps)***

- 📍 City of Mulberry will obtain and utilize AFC BMP manuals for their own property and when working with landowners in their drinking water source watershed
- 📍 City of Mulberry and Mulberry River Society will start collaborating and will meet soon
- 📍 Mulberry River Society will increase US Forest Service contact and involvement to take advantage of their expertise
- 📍 Conduct a watershed-wide stakeholder meeting in early 2017
- 📍 Use social media to promote importance of maintaining water quality resources, and programs/information about BMPs
- 📍 Explore timber management as potential revenue source to fund source water protection
- Identify all property owners along riparian corridors and invite landowners to an event to explain Mulberry River and City of Mulberry watershed protection needs and efforts
- Develop watershed management plan and/or nine-element source water protection plan.
- Approach ANRC about 319 grant (there is a current focus on maintaining water quality for rare fish and wildlife species)
- Also apply for unpaved road grant program with AR Department of Rural Services for forest road management to protect water quality
- Explore creating local funding mechanisms for supporting voluntary source water and Mulberry River protection

**Lee Creek/Frog Bayou Watershed and Regional Watersheds (Beaver Lake, Illinois River, Little Sugar Creek, Kings River) Breakout Group Discussion** (Bob Morgan, Ken Leonard, Tim Snell, Bob Caulk, Mike Schorpp, Carole Jones)

***What's already going on in the Lee Creek/Frog Bayou watershed?***

- 📍 City of Fort Smith has nine-element watershed management plan,
- 📍 Northwest Arkansas Land Trust is active in the watershed
- 📍 City of Fort Smith is working with USFS on studying Lee Creek and Frog Bayou hydrology.
- 📍 A portion of Lee Creek is within the scope of the NW Arkansas Open Space Plan.

***Is there a watershed management plan?***

- 📍 Lee Creek and Frog Bayou both have approved nine-element watershed management plans.
- 📍 Beaver Lake and Illinois River both have approved nine-element watershed plans.
- 📍 Kings River has a watershed management plan but unclear if it is an approved nine-element plan.
- 📍 Beaver, Illinois River, Lee Creek and Frog Bayou watersheds share geographic boundaries/divides.

### ***Who are the key players?***

- ☞ Northwest Arkansas Land Trust,
- ☞ United States Forest Service (USFS),
- ☞ City of Fort Smith Water Utility,
- ☞ Landowners,
- ☞ US Endowment for Forestry and Communities,
- ☞ Beaver Watershed Alliance, Illinois River Watershed Partnership, Friends of Little Sugar Creek are active in adjacent or nearby watersheds.

### ***Strengths, Weaknesses, and Opportunities***

Efforts are primarily in the “building momentum,” “design,” “implementation” and “Maintaining” phases. There is limited outreach to landowners in these watersheds (with the exception of Beaver Lake Watershed), no dedicated source of watershed protection funding (with exception of Beaver Lake Watershed), and watershed champions are needed in the other watersheds. Also need assistance educating the public and making the case for sustainable source water protection, NW Arkansas Open Space Plan, and land conservation funding.

### ***Priority and Long-term Actions (☞ indicates priority actions or next steps)***

- ☞ Identify watershed champions
- ☞ Ask funders (US Endowment for Forestry and Communities, NRCS, ADEQ, and others) about potential to fund land purchases for watershed protection
- ☞ Identify successful timber owners and allow tours/demonstrations
- ☞ Education/outreach - many landowners don't know they can get free assistance to develop a forestry plan
- ☞ Promote registered and educated foresters – help them get their license and train them in the process about watershed protection practices
- Seek funding for purchase of land for conservation and successful program demonstration (focus on existing forests as priority per Cadmus presentation)
- For Illinois River and Beaver Lake watersheds, grow NW Arkansas Open Space Plan to purchase "large chunks" of land for multi-benefit conservation (seek funding from Healthy Watersheds Consortium, NRCS and other likely funders)
- Explore creative ways to fund sustainable long-term watershed protection management (such as lake use fees, fees attached to utility bills, trail use fees, timber revenue, etc.)
- Help land trusts hire more staff and/or volunteers to conduct regular monitoring
- Enforce current regulations for illegal dumping, etc.
- Comments recorded relevant to the Beaver Lake Watershed:
  - For Beaver Lake watershed, ask Army Corps of Engineers to buoy off/sign areas to prevent boats from causing wake damage to shoreline in sensitive areas
  - Update Beaver Lake Watershed Protection Plan to include value of forests and having registered foresters
  - Also mentioned exploring use fees for Beaver Lake to help fund protection efforts in the Beaver Lake watershed.

**Beaver Lake Watershed Breakout Group Discussion** (George Rheinhardt, Jim Woodruff, Angela Danovi, Melissa Welch, John Pennington, Alan Edmonston, Joel Jones)

***What's already going on in the Beaver Lake Watershed?***

- ☞ Multiple active watershed organizations,
- ☞ Multiple active land trusts,
- ☞ Approved nine-element watershed protection plan,
- ☞ Sustained landowner engagement,
- ☞ NW Arkansas Open Space Plan,
- ☞ Rapid growth and development resulting in conversion of key forest lands, creating need.

***Who are the Key players?***

- ☞ Beaver Watershed Alliance,
- ☞ Beaver Water District,
- ☞ Northwest Arkansas Land Trust,
- ☞ Watershed Conservation Resource Center,
- ☞ Landowners,
- ☞ NRCS,
- ☞ Arkansas Water Resources Center,
- ☞ Ozarks Water Watch,
- ☞ Arkansas Forestry Commission,
- ☞ Arkansas Forestry Association,
- ☞ Benton Washington Regional Water Authority,
- ☞ Carroll-Boone Water District,
- ☞ Madison County Regional Water District.

***Strengths, Weaknesses, and Opportunities***

Currently in design, implementing, and maintaining phase. Beaver Watershed Alliance is a Champion. Buy into to sustainable source water protection/investment in natural infrastructure still needed by three water utilities on Beaver Lake. Needs include funding for stream bank restoration, thinning, burning, land acquisition; technical assistance for landowners (AFC and private contractors either are spread too thin or won't work with smaller acreages).

***Priority and Long-term Actions*** (☞ indicates priority actions or next steps)

- ☞ Middle of October to get proposal for Joint Chief Project – NRCS – for forest management and bank stabilization in the National Forest and Beaver Lake Watershed.
- ☞ Increase forest management workshops from two to four per year
- ☞ Increase development/implementation of forest management plans and wildlife management plans on privately owned forest lands (they are free but AFC is at capacity)
- ☞ Encourage landowners to work with registered foresters
- ☞ Continue to seek sustainable funding from the other three water utilities on Beaver Lake
- ☞ Create Prescribed Burn Teams with four or more people, and prioritize their work
- ☞ Increase messaging about importance of forests and fields for good water quality, maybe with a "Forest and Field to Faucet" publication
- Establish watershed forest demonstration sites on private lands in each county

- Create and disseminate message for landowners: this is what you can do for your land to manage your forest to help the watershed
- Increase native warm season grasses and forbs on inactive pastureland.
- Implement unpaved road improvements for forest management and water quality BMPs like wing ditches, culverts, grading, stream crossings and road base material type

**Russellville/Waldron/Conway/Mulberry Watershed Breakout Group Discussion**

*(Darcia Routh, Hal Liechty, Jeff Berry, Trey Lieblong, Brandon Nelson, Johnathan Shipley, Jeremy Howell)*

***What's already going on in this region?***

All communities in this watershed have source water protection plans. Conway has a new agreement with Green Bay Packaging (forest products company) to manage forest in Lake Brewer watershed to help improve water quality and generate source water protection income.

***Who are the Key players?***

- ☞ Multiple city water utilities,
- ☞ Green Bay Packaging Corporation and other landowners,
- ☞ Arkansas Rural Water Association
- ☞ Arkansas Department of Health,
- ☞ Cooperative Extension Service,
- ☞ NRCS,
- ☞ Arkansas Forestry Association
- ☞ Arkansas Forestry Commission,

***Strengths, Weaknesses, and Opportunities***

Currently in the building momentum phase. Need education/outreach to community as well as city drinking water utility managers and staff. Need help with updating and implementing existing source water protection and watershed management plans to strengthen forest-drinking water connection. Need examples of outreach materials that could be easily modified and distributed.

***Priority and Long-term Actions (☞ indicates priority actions or next steps)***

- ☞ Community Organizing - organize a Watershed Steward Workshop (to be held in the Fall) focused on how to engage and involve watershed protection partners and stakeholders
- ☞ Build on and update/enhance existing utility source water protection plans - Use the above workshop to build community support for enhanced watershed protection, get buy-in from drinking water utilities, landowners and others.



## Attachment A

### Arkansas Forests and Drinking Water Forum Participants

Last Name	First Name	Title	Organization	Phone Number	Email Address
Akin	Doug	Assistant State Forester	Arkansas Forestry Commission	(501) 944-2175	doug.akin@arkansas.gov
Arthur	Sharon	Board Member	Washington County Conservation District	(479) 369-2805	sharonarthur.wccd@gmail.com
Berry	Jeff	Landowner Resource Forester	Green Bay Packaging	(501) 208-2372	jberry@gbp.com
Borman	Scott	General Manager	Benton Washington Regional Public Water Auth	(479) 925-7655	scott.borman@bwrpwa.com
Braswell	Max	Executive Vice President	Arkansas Forestry Association	(501) 374-2441	mbraswell@arkforests.org
Caulk	Bob		Beaver Watershed Alliance	(479) 973-2968	bobcaulk@cox.net
Danovi	Angela	Regional Projects Director	Ozarks Water Watch	(479) 295-7717	adanovi@ozarkswaterwatch.org
Davis	Jim			(479) 856-5858	gohogs751@gmail.com
Davis	Marsha			(479) 856-5858	gohogs751@gmail.com
Earnest	Hugh	President	Mulberry River Society	(479) 841-8549	hughearnes12002@yahoo.com
Edmondson	Alan	Land Stewardship Specialist	Northwest Arkansas Land Trust	(479) 966-4666	aedmondson@nwalandtrust.org
Hameister	Arnold	BMP Coordinator	Arkansas Forestry	(501) 472-4834	arnold.hameister@arkansas.gov
Haggard	Brian	Director and Professor	Arkansas Water Resources Center	(479) 575-2879	haggard@uark.edu
Hallett	Sarah	Conservation Intern	Beaver Watershed Alliance	(479) 750-8007	sarah@beaverwatershedalliance.org
Howell	Jeremy	Public Works Director	City of Waldron	(479) 637-3181	lavadaallen@cebridge.net
Hufhines	Brad		Beaver Water District	(479) 756-3651	bhufhines@bwtd2o.org
Jones	Joel		Private landowner	(479) 855-0922	dakota15@cox.net
Jones	Carole	Owner	Cantique Consulting Engineering		cdjonespe@gmail.com
Klinger	Timothy		Capps Valley Farms	(479) 442-3779	tklinger@hpa-106.com
Krop	Richard	Principal	The Cadmus Group, Inc.	(424) 291-7678	richard.krop@cadmusgroup.com
Lane	Terry	Executive Director	Northwest Arkansas Land Trust	(479) 966-4666	tlana@nwalandtrust.org
Leonard	Ken	Master Naturalist	Arkansas Master Naturalists	(479) 366-9929	kenleonard57@gmail.com
Lieblong	Trey	Environmental Coordinator	Conway Corporation	(501) 548-3040	trey.lieblong@conwaycorp.com
Liechty	Hal	Professor	Univ. of AR School of Forestry	(870) 460-1452	liechty@uamontau
Maginot	Jana	Program Associate	UA Cooperative Extension Service	(479) 444-1755	jmaginot@uaex.edu
Meek	Scott	SFI Coordinator	Green Bay Packaging Inc.	(501) 354-2461	smeek@gbp.com
Moore	Robin G	Registered Agent	Aremores, LLC	(870) 420-3227	aremores@ritternet.com
Morgan	Bob	Mgr. Environmental Quality	Beaver Water District	(479) 756-3651	rmorgan@bwtd2o.org
Nelson	Brandon	City Superintendent	Waldron Water & Wastewater	(479) 637-3181	lavadaallen@cebridge.net
Ogle	Jennifer	Program Coordinator	Beaver Watershed Alliance	479-750-8007	jennifer@beaverwatershedalliance.org
Ostner	Alan	Landscape Architect	Outdoor Rooms	(479) 387-7900	alan.72701@gmail.com
Ouei	Trish		UA Cooperative Extension Service	(479) 271-1060	pouei@uaex.edu
Pennington	John	Executive Director	Beaver Watershed Alliance	(479) 970-3550	john@beaverwatershedalliance.org
Phipps	Channon	Asst. Water Superintendent	City of Mulberry	(479) 997-1321	monica@cityofmulberry.org
Puckett	Katie	Assistant Biologist	City of Fort Smith	(479) 806-4520	kyoder00@yahoo.com
Rheinhardt	George	Forester	NRCS	(501) 301-3143	george.rheinhardt@ar.usda.gov
Routh	Darcia	Geologist Supervisor	Engineering/AR Dept. of Health	(501) 661-2856	darcia.routh@arkansas.gov
Schorpp	Mike		City of Bella Vista	(479) 268-4880	mschorpp@bellavistaar.gov
Scott	John	Urban Forester	City of Fayetteville	(479) 444-3470	jscott@fayetteville-ar.gov
Shipley	Jonathan	Water Operations Manager	City Corporation of Russellville	(479) 968-1148	jcs@citycorporation.com
Snell	Tim	State Director	The Nature Conservancy	(479) 957-6204	tsnell@inc.org
Van Eps	Matthew	Associate Director	Watershed Conservation Resource Center	(479) 444-1916	wrcrc@watershedconservation.org
Welch	Melissa	Outreach Coordinator	Beaver Watershed Alliance	(479) 970-3550	melissa@beaverwatershedalliance.org
Westbrook	Erica	Asst. State Conservationist	NRCS	(479) 646-8300	erica.westbrook@ar.usda.gov
Williams	Wendi	Science Faculty	NorthWest Arkansas Community College	(479) 601-9778	williams@nwacc.edu
Woodruff	Jim	President	Artex Properties, Inc. (Tree Farm)	(479) 636-1180	jawoodruff1@cox.net

# Attachment B

## Northwest Arkansas Forests and Drinking Water Workshop

### Agendas

#### NW Arkansas Forests & Drinking Water Regional Partnership Workshop

The Chancellor Hotel  
70 North East Avenue  
Fayetteville, AR 72701  
(479) 442-5555

***Thursday September 15, 2016***

*Parking is available in the garage behind the Chancellor Hotel for \$4.00, or valet is available for \$10.00*

3:00 pm      **REGISTRATION at the Chancellor Hotel in the Bella Vista room**  
Located on the 2<sup>nd</sup> floor

**Watershed Tour - Sediment and Phosphorus Removal and Riparian Buffers Projects**

Matt Van Eps, Hal Liechty

3:30 pm      Razorback Transit Departs

3:40 pm      Mullins Creek Stream Restoration Site

4:05 pm      Drake Field Stream Restoration Site

4:50 pm      UA Riparian Buffer Demonstration Site

6:00 pm      **Arkansas Forests and Drinking Water Dinner Social - Group**

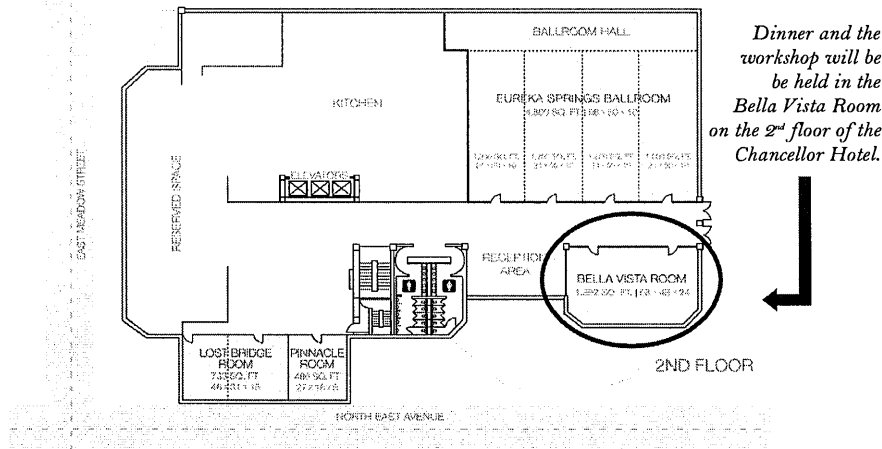

*Dinner and the workshop will be held in the Bella Vista Room on the 2<sup>nd</sup> floor of the Chancellor Hotel.*

*Forum sponsors:*

Arkansas Forestry Association  
Arkansas Forestry Commission  
Arkansas Forest Resources Center  
Arkansas Water Resource Center  
Beaver Watershed Alliance  
Beaver Water District

Ozark-St. Francis National Forest  
Ozarks Water Watch  
Multi-Basin Regional Watershed Council  
South Eastern Partnership for Forests & Water US  
Endowment for Forestry & Communities  
University of Arkansas

# NW Arkansas Forests & Drinking Water Regional Partnership Workshop

The Chancellor Hotel  
70 North East Avenue  
Fayetteville, AR 72701  
(479) 442-5555

***Friday September 16, 2016***

- 8:00 am      **REGISTRATION** at the Chancellor hotel in the Bella Vista Room  
*Located on the 2<sup>nd</sup> floor*
- 8:30 am      **Welcome, Background and Workshop Objectives** – Bob Morgan
- 8:45 am      **Introductions and Affiliations** - Group
- 9:00 am      **Anatomy of Successful Watershed Protection** – Brian Haggard & Richard Krop
- Watershed success factors
  - Funding – with an emphasis on developing local sustainable funds, overview of grant sources
  - Investment in natural infrastructure – forest retention & BMP's
- 9:30 am      **Local and Regional Success Stories for Water Supply Protection** – Arnold Hameister, Jeff Berry, Bob Morgan, John Pennington, Jim Woodruff & Matt Van Epps
- 10:30 am      **BREAK**
- 10:45 am      **Facilitated Group Discussion of watershed needs, organizational needs, and funding needs**
- 11:45 am      **LUNCH**
- 12:45 pm      **Breakout Group Discussions Leading to Follow-Up Actions**
- 2:30 pm      **BREAK**
- 2:45 pm      **Breakout Groups Present Findings**
- 3:15 pm      **Workshop Wrap Up – Action Items & Schedule**
- 3:30 pm      **ADJOURN**

---

*Forum sponsors:*

Arkansas Forestry Association  
Arkansas Forestry Commission  
Arkansas Forest Resources Center  
Arkansas Water Resource Center  
Beaver Watershed Alliance  
Beaver Water District

Green Bay Packaging  
Ozark-St. Francis National Forest  
Ozarks Water Watch  
Multi-Basin Regional Watershed Council  
South Eastern Partnership for Forests & Water US  
Endowment for Forestry & Communities